

CITY OF GOTHENBURG ZONING DISTRICT MAP 2009

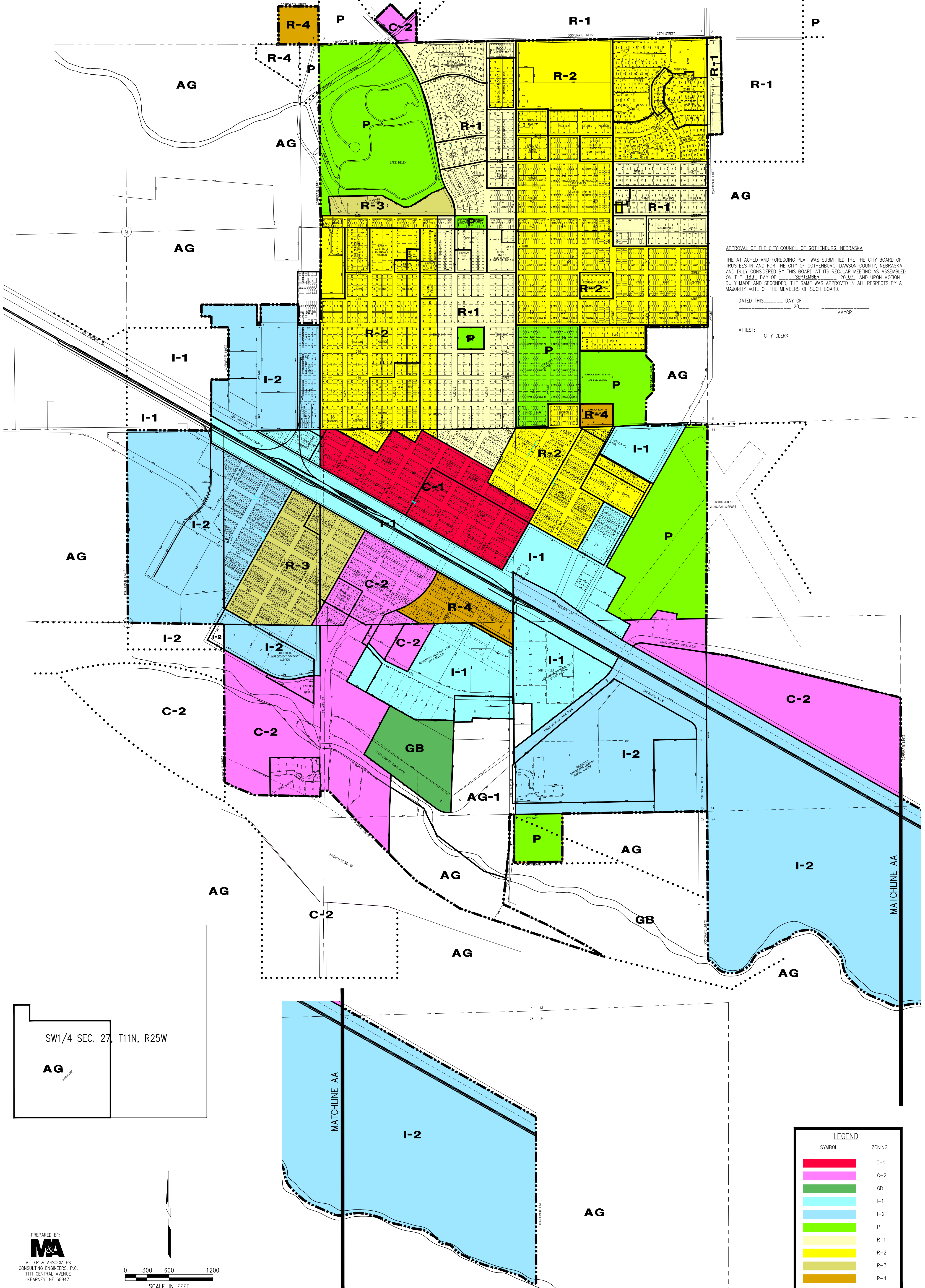

APPROVAL OF THE CITY COUNCIL OF GOTHENBURG, NEBRASKA

THE ATTACHED AND FOREGOING PLAT WAS SUBMITTED TO THE CITY BOARD OF TRUSTEES IN AND FOR THE CITY OF GOTHENBURG, DAWSON COUNTY, NEBRASKA, AND DULY CONSIDERED BY THIS BOARD AT ITS REGULAR MEETING AS ASSEMBLED ON THE 18th DAY OF SEPTEMBER 2007, AND UPON MOTION DULY MADE AND SECONDED, THE SAME WAS APPROVED IN ALL RESPECTS BY A MAJORITY VOTE OF THE MEMBERS OF SUCH BOARD.

DATED THIS _____ DAY OF _____ 20____ MAYOR

ATTEST: _____ CITY CLERK

SW1/4 SEC. 27, T11N, R25W

AG

LEGEND	
SYMBOL	ZONING
[Red Box]	C-1
[Pink Box]	C-2
[Green Box]	GB
[Light Blue Box]	I-1
[Dark Blue Box]	I-2
[Light Green Box]	P
[Yellow Box]	R-1
[Light Yellow Box]	R-2
[Light Green Box]	R-3
[Orange Box]	R-4

PREPARED BY:
MA
MILLER & ASSOCIATES
CONSULTING ENGINEERS, P.C.
1111 CENTRAL AVENUE
KEARNEY, NE 68847

